

Surname	Centre Number	Candidate Number
First name(s)		0



**GCSE**

C990UB0-1



**TUESDAY, 21 JUNE 2022 – AFTERNOON**

**LATIN – Component 3B**  
**Roman Civilisation**

1 hour

For Examiner's use only		
Topic 3 or 4	Maximum Mark	Mark Awarded
	40	

C990UB01  
01

**INSTRUCTIONS TO CANDIDATES**

Use black ink or black ball-point pen. Do not use gel pen or correction fluid.  
Write your name, centre number and candidate number in the spaces at the top of this page.  
You should answer **either** Topic 3 (Daily Life in a Roman Town) **or** Topic 4 (Roman Britain).  
Write your answers in the spaces provided in this booklet. If you run out of space, use the additional page(s) at the back of the booklet, taking care to number the question(s) correctly.

**INFORMATION FOR CANDIDATES**

The total mark available for this paper is **40**.  
The number of marks is given in brackets at the end of each question or part-question.



JUN22C990UB0101

**Answer either Topic 3 or Topic 4.**

**Topic 3: Daily Life in a Roman Town**

Answer **all** questions.

1. Look at this picture of a garden in a house in Herculaneum and answer the questions.



- (a) Using the picture as a starting point, give **three** features, apart from plants, commonly found in the garden area of a Roman town house. [3]

- .....
- .....
- .....

- (b) Explain why the garden area would have been important for the people who lived in the house. Make **two** points. [2]

.....

.....

.....

.....



(c) What evidence of the worship of the gods has been found in Roman town houses? [1]

.....

(d) To what extent do you think Roman families would have enjoyed living in town houses?  
Make **two** points and explain your views. [4]

.....  
.....  
.....  
.....  
.....  
.....  
.....  
.....  
.....  
.....

C990UB01  
03

10



2. Read this poem by Martial and answer the questions.

How much longer have I got to turn up to these early-morning buttering-up sessions, mingling with the mob of followers and little men all done up in their posh togas? And for what? A handful of cash for a full day's work.

(a) (i) What occasion is Martial describing here? [1]

.....

(ii) Explain the reference to 'a handful of cash' in the last line. [1]

.....

.....

(b) To what extent do you think the system of patrons and clients benefitted the clients? Make **three** points and explain your views. [6]

.....

.....

.....

.....

.....

.....

.....

.....

.....

.....

.....

8



3. Look at this picture of a laundry in Pompeii and answer the questions.



(a) How is the feature labelled **X** different from a pool normally found in the main room in many town houses? Explain the reason for the difference. [2]

.....

.....

.....

.....

(b) Apart from water, give **one** substance which would have been used in a laundry like this. [1]

.....

(c) Explain why working in a laundry like this might have been unpleasant. Make **two** points and explain your views. [4]

.....

.....

.....

.....

7



4. Look at this picture from Herculaneum and answer the questions.



X

(a) How was the feature marked X used? Tick (✓) the correct box. [1]

To keep food and drink

To store valuables

To wash hands

(b) Why would a building like the one shown here be important to people living in a Roman town? Make **two** points. [2]

.....

.....

.....

.....

.....

.....

3





A large rectangular area containing 25 horizontal dotted lines, intended for writing or marking.





**Topic 4: Roman Britain**

Do not answer this topic if you have answered Topic 3.

Answer **all** questions.

1. Look at this plan of the legionary fortress at Chester (Deva) and answer the questions.

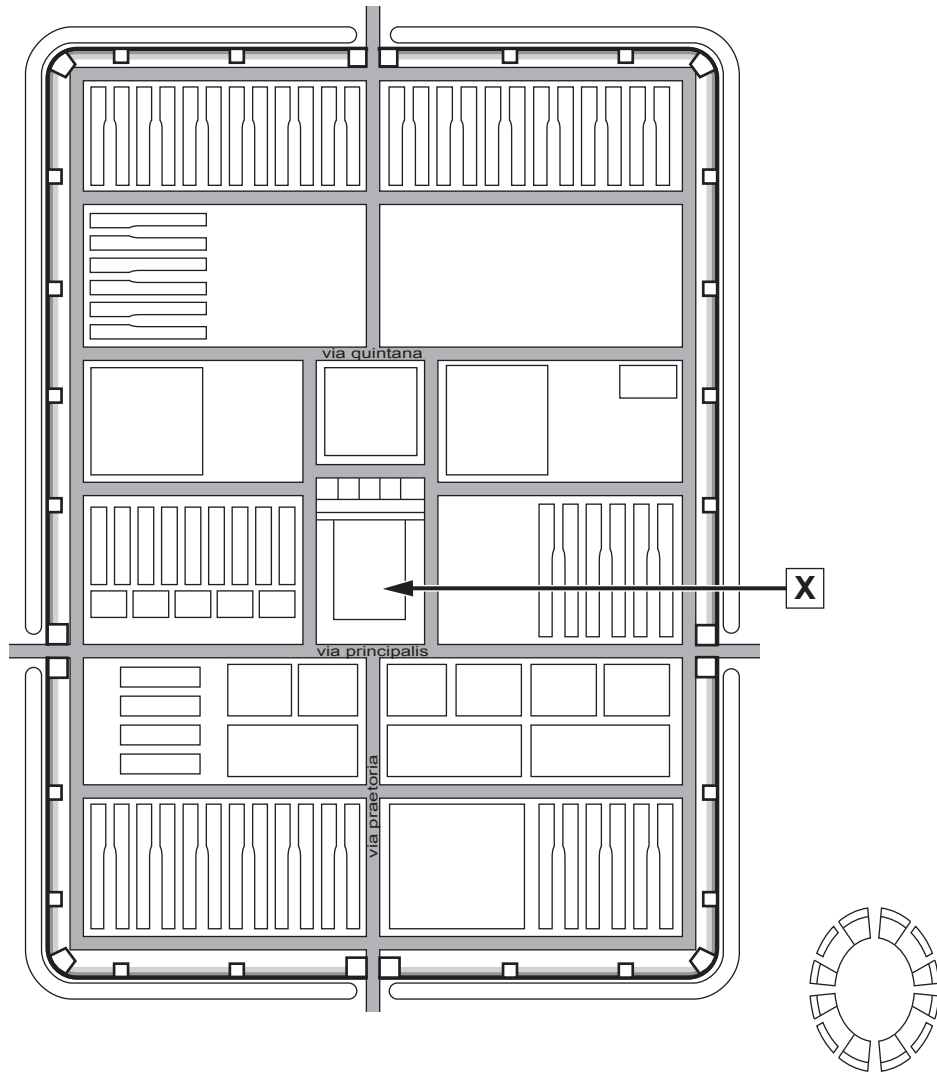

(a) What, in this plan, suggests that the headquarters building (*principia*), labelled **X**, was the most important building in the fortress? Make **two** points. [2]

.....

.....

.....

.....

(b) What would have impressed a visitor to the headquarters building (*principia*)? Make **three** points. [3]

.....

.....

.....

.....

.....

(c) What leisure opportunities would there have been for a soldier inside the fortress? Give **one** example. [1]

.....

(d) Why would those living and working in the fortress have felt safe? Make **two** points and explain your views. [4]

.....

.....

.....

.....

.....

.....

10



2. Look at this plan of the baths complex at Aquae Sulis and answer the questions.

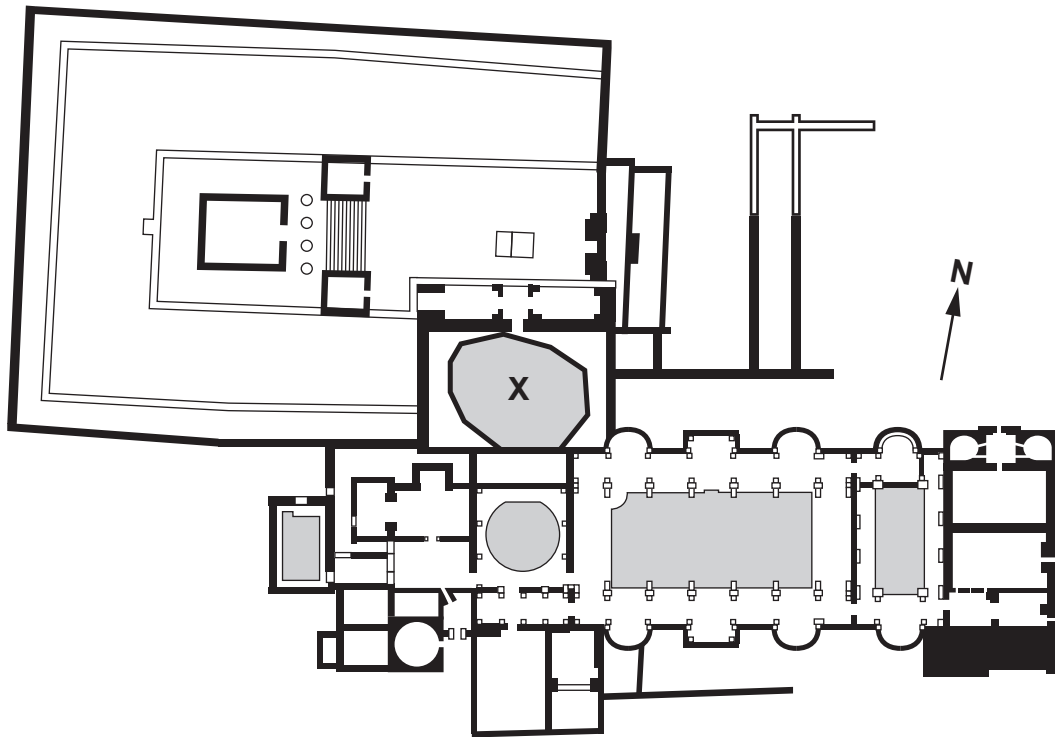

(a) What is the feature labelled **X**?

[1]

.....

(b) Why do you think the Romans chose to build the baths and temple complex on this site?  
Give **two** reasons.

[2]

.....

.....

.....



(c) The temple was dedicated to Sulis Minerva. Why might some people have wanted to worship this goddess? Tick (✓) the correct box. [1]

She was the goddess of healing.

She was the goddess of the sun.

She was the goddess of travellers.

(d) To what extent might a visitor to Aquae Sulis have been filled with a sense of amazement and wonder? Make **two** points and explain your views. [4]

.....

.....

.....

.....

.....

.....

.....

.....

.....

.....

.....

.....

8



3. Look at this extract from Tacitus and answer the questions.

The nearest part of Britain was gradually made into a province. A colony of veteran soldiers was set up there. Some tribal states were handed over to King Cogidubnus who has remained completely loyal down to our own times. This is a good example of how we Romans use even kings to help us make people slaves.

(a) (i) According to the extract, why is Tacitus praising Cogidubnus? [1]

.....  
.....

(ii) What seems to be the attitude of the Romans towards the Britons? Make **two** points and support your view with evidence from the extract. [4]

.....  
.....  
.....  
.....  
.....

(b) Using your own knowledge, state what other help Cogidubnus gave to the Romans? Give **one** example. [1]

.....

6



4. Look at this picture of a Roman road in Britain and answer the questions.



Using the picture to help you, explain how the Romans improved the experience for travellers in Britain and what difficulties still remained. Give **one** example of each and explain your view. [4]

An improvement was .....

.....

.....

A difficulty was .....

.....

.....

4





Examiner  
only

A large rectangular area containing 25 horizontal dotted lines, intended for writing or marking.







